



EN: Read all instructions before operating..



DESIGNED TO
OUTPERFORM



ultra45

**∞
ultraX**

- Machine Overview 4
- Control Panel..... 6
- DON'T DO 8
- DO / DON'T DO10
- Useful Information12
- Contents & Quick Setup Guide14
- Transportation & Storage.....20
- Battery Removal & Charging.....20
- Daily Maintenance.....22
- Periodic Maintenance24
- Technical Data.....30
- Troubleshooting31
- Rating Label.....32
- Information: Use & Maintenance,
Warnings, Caution33
- Battery Safety & Disposal33
- Battery Label.....34
- CE Certification Page.....39
- Contact Information40

MACHINE OVERVIEW

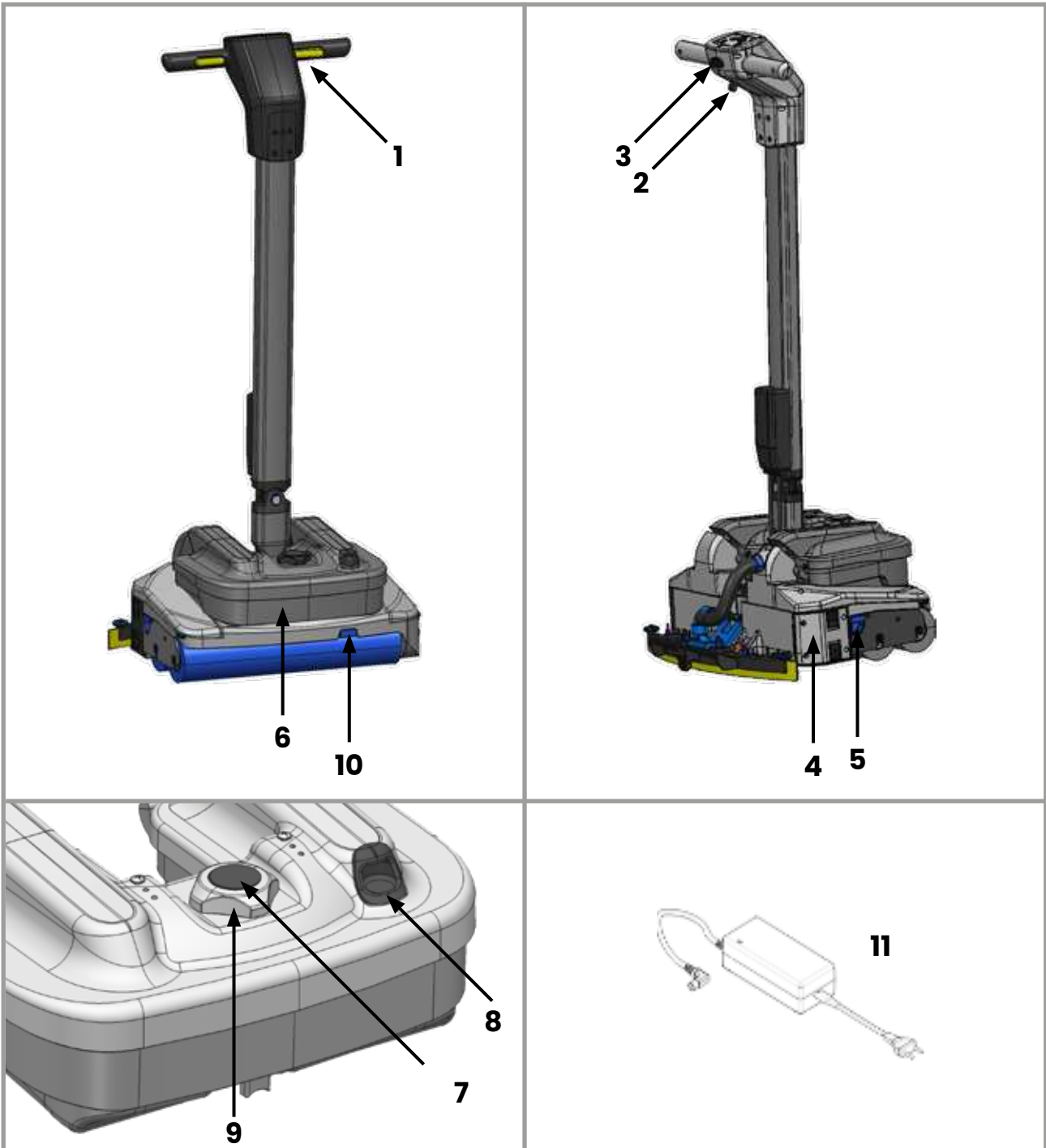

- 1. Activation lever
- 2. Handle release lever
- 3. Handle lock button
- 4. Battery
- 5. Debris tray
- 6. Clean/dirty water tank

- 7. Quick-fill cap (clean water)
- 8. Quick-empty cap (dirty water)
- 9. Tank-access cap (deep cleaning)
- 10. Parking stand
- 11. Battery charger

CONTROL PANEL



1 Water (lights = minutes left)

- 1 light = minimum
- 4 lights = maximum

Note: If water ends, the machine stops and the water light flashes; it won't restart for 2 minutes unless the battery is removed/reinserted.

2 Battery indicator

3 Vac Motor (HI / LO / OFF)

Note: Stops automatically if the dirty tank is full.

4 Bin:

flashes when the debris tray is full



MIN: Less water & brush speed (daily)



MED: More water & brush speed (intensive)



MAX: High water, brush speed & suction (deep)

(These settings auto-adjust water, brush speed, and suction. You can still adjust them individually if needed.)

DON'T DO

1



Attention

Do not use foamy chemicals.



2



Attention

Only use chemicals with pH 6–8.



3



Note *The machine cleans very well with just water.*

4



Attention

Do not tilt the machine if the tank is full; remove the tank first.

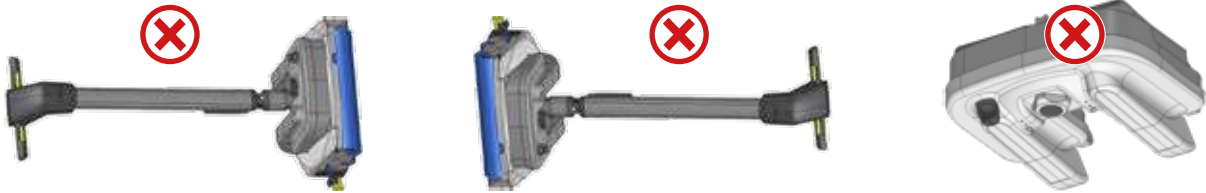

5



Attention

Ensure dirty-water and quick-fill caps are tightly closed.



6



Attention

Do not open the main lid for fresh water; use the quick-fill cap.

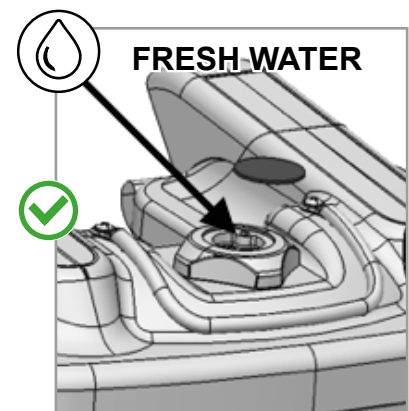
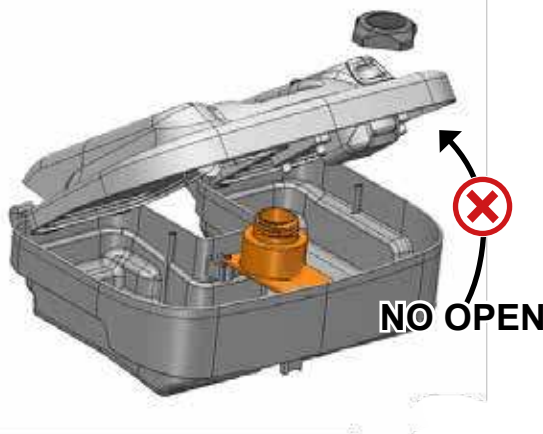

DO / DON'T DO

1



Attention

Do not place the baffle on the tank—attach it to the lid.

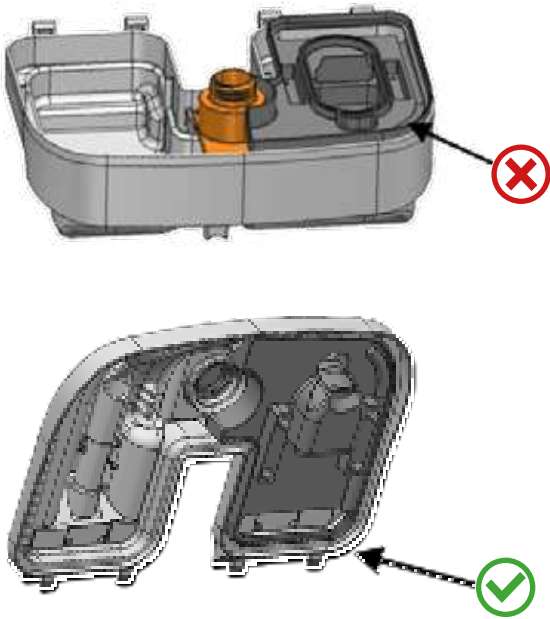

2



Attention

Do not spray water directly onto the machine.



Remove the brushes

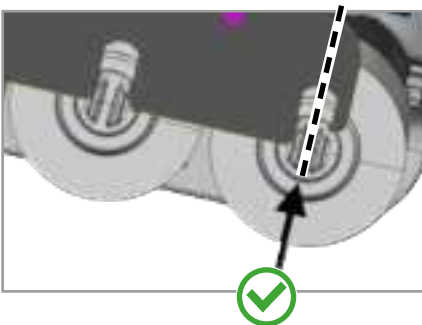

Align interlocking springs

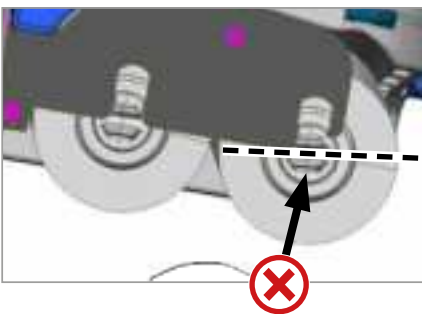

do not force if misaligned.

3

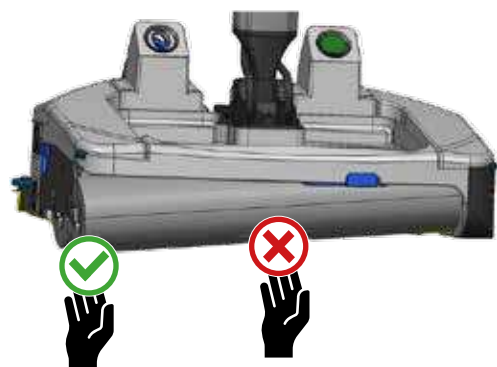

Remove/Insert brushes as needed.

USEFUL INFORMATION

1



Note: For most jobs, use **MIN** to save battery and water.

2



Note: The vacuum motor stops if the dirty tank is full.

3



Note: The machine and pump stop when the fresh-water tank is empty.

TANK CLEANING

4

Note: For daily tank cleaning, pour water into the dirty inlet, shake, and repeat twice (no need to open the main lid).

NO OPEN

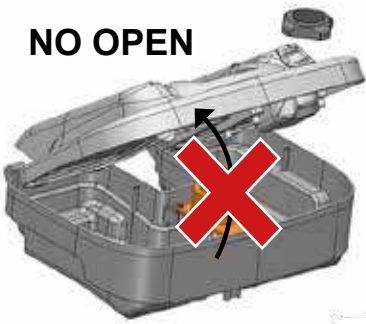

1

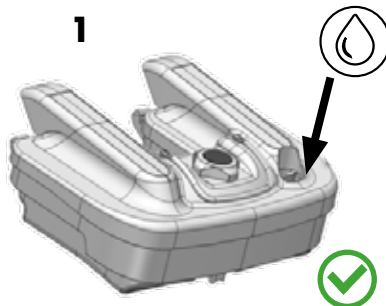

INSERT CLEAN WATER

2



5



Note: The brush motor slows automatically on high-friction floors; use microfiber rollers if needed.

CONTENTS

- Owner Manual
- Battery Charger
- Battery Pack
- 2 Scrub Brushes
- Squeegee Assembly

PLEASE READ BEFORE USE
Check all items after unpacking.

QUICK SETUP

Remove the brushes

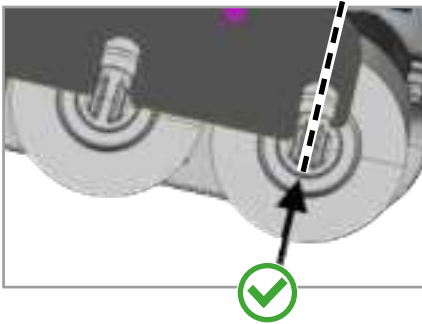

1

Align interlocking springs

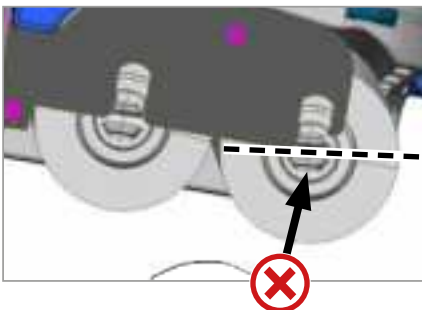

do not force if misaligned.

Insert the brushes

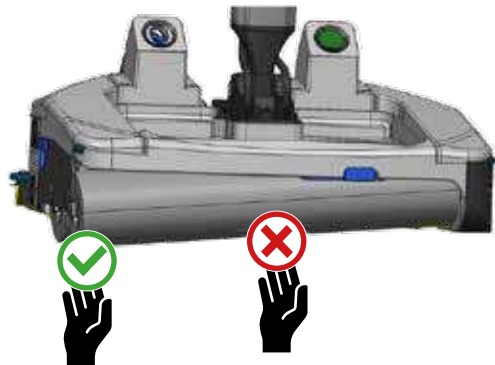

Remove/Insert brushes as needed.

2

Empty the Recovery Tank

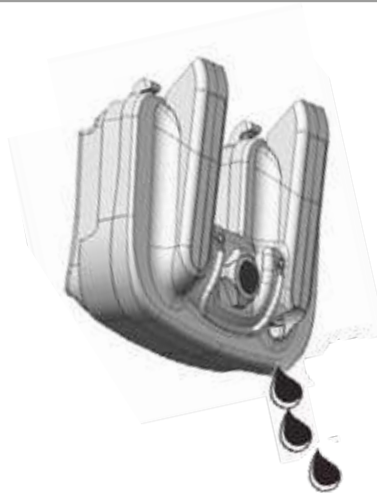

3



Attention: Remove quick-fill cap;

Add clean water (pH 6–8).

No foamy chemicals.

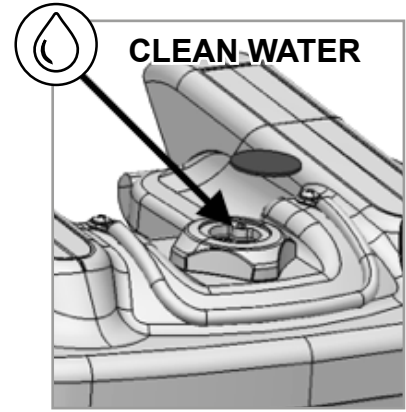

4



Attention: Ensure both quick-refill and dirty-water caps are correctly positioned.



5

6



Attention: Ensure the squeegee hose is firmly connected at both ends.

(Placeholder for a missing step)

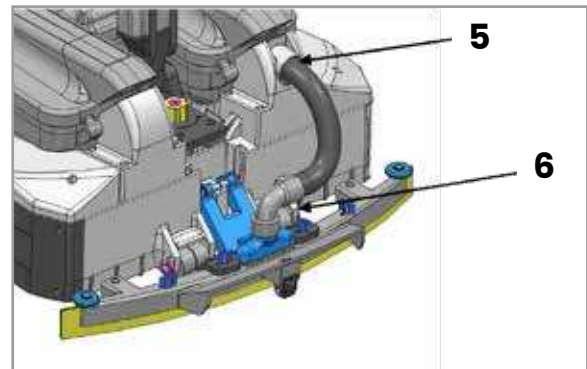

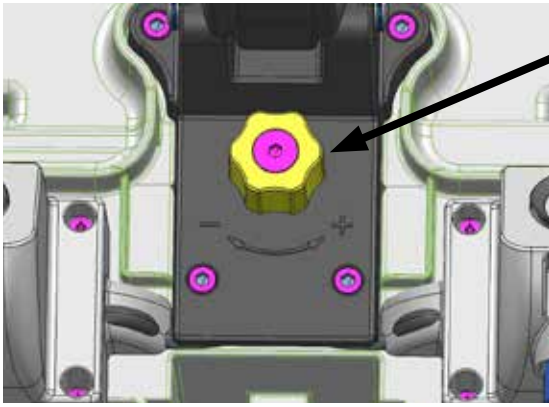

7 PRESSURE SELECTION

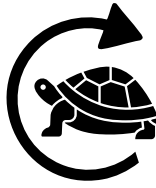

Turn left = higher brush pressure, slower speed



Turn right = lower pressure, faster speed (rubbery or porous floors)

8 INSERT BATTERY

9 PRESS ACTIVATION LEVER



Note: MIN is sufficient for most tasks; water & suction start automatically



11 Pull the lever until it clicks (if no click, it re-locks).



12 Press the activation lever to move.

TRANSPORT

1

Lock the handle (press lock button).



2

Note: The machine automatically shuts off after 5 minutes of inactivity—no need to press anything.

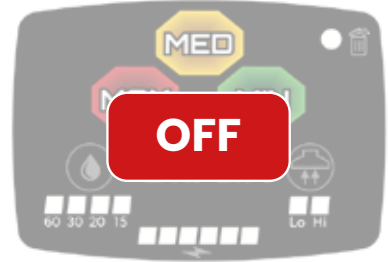

3

Tilt the machine to move it.

3



STORAGE

1

Lift the suction tool.

2

Remove the tank if storing for a long period.

4

5



BATTERY REMOVAL & CHARGING

1

Remove the battery with both hands; pull from the side ridge.

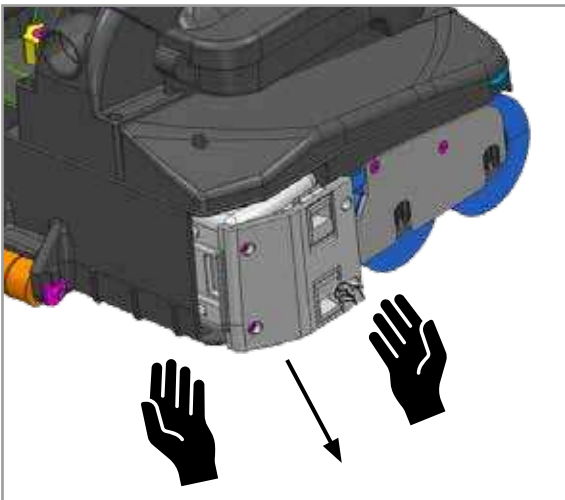

2

Insert the charger into the battery port.

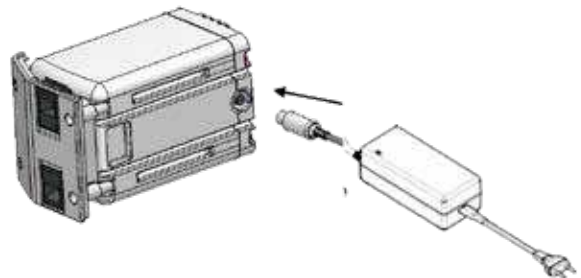

DAILY MAINTENANCE

1 Tank Cleaning

1.1



Remove the quick-empty cap; drain the tank.

EMPTY DIRTY WATER

1.2



INSERT
CLEAN
WATER

Add fresh water via the dirty-water opening; shake.

1.3



EMPTY DIRTY WATER

Repeat twice for a thorough clean.

No need to unscrew the tank lid for daily cleaning.

2

Remove the debris tray; clean thoroughly.



3

Clean the machine & brushes

Pour water on the floor, run the machine over it, and vacuum it up. Repeat $\times 2$.

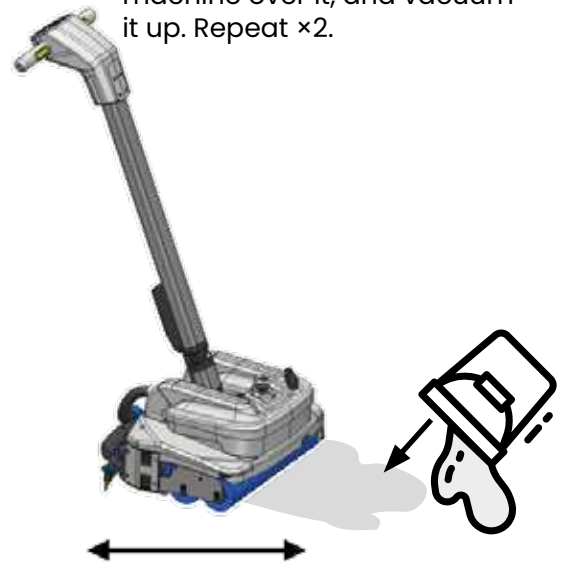

Note: You do not need to open the screw-lid for daily tank rinsing; fill via the dirty inlet, shake, repeat $\times 2$.

PERIODIC MAINTENANCE

1

Tank deep Cleaning:

Open the tank
(unscrew the cap)
and wash it.

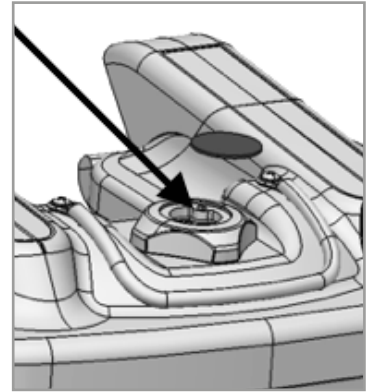
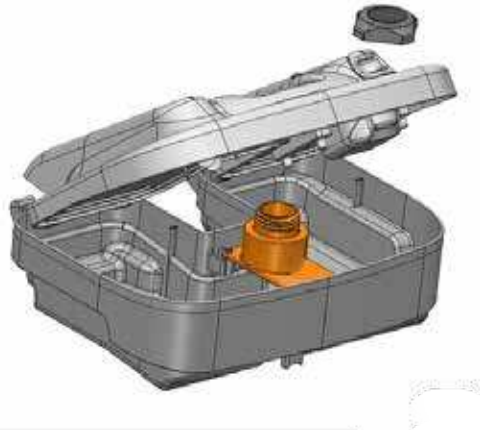

2

Remove the yellow baffle; rinse the float chamber thoroughly.

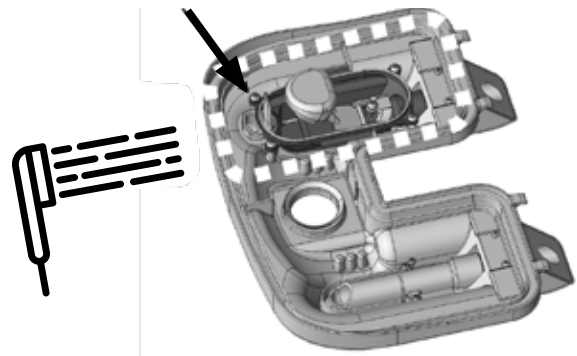

3

Check the suction chimney for debris.

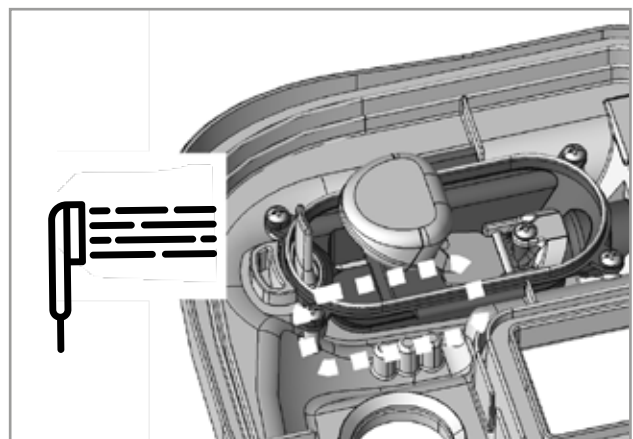

4

Reinstall the baffle on the lid, not on the tank.

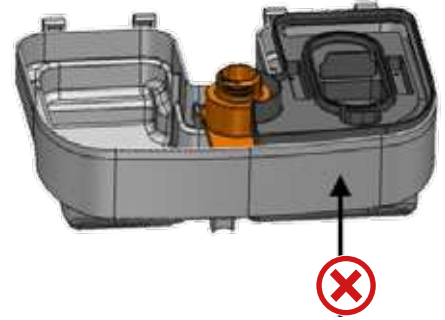
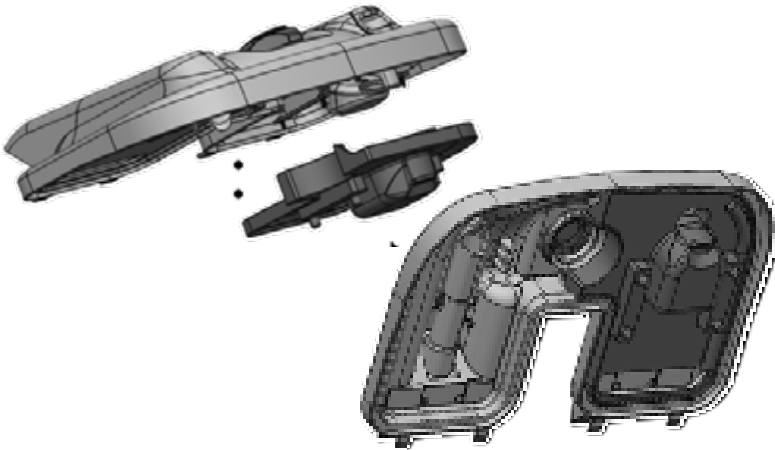

5

Allow parts to dry before using.

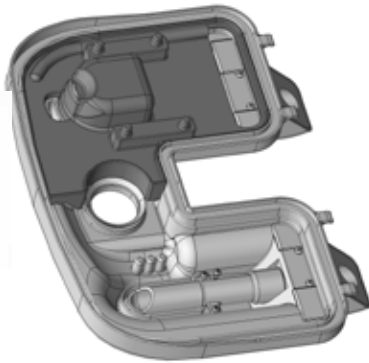

6

Clean the suction interconnection.

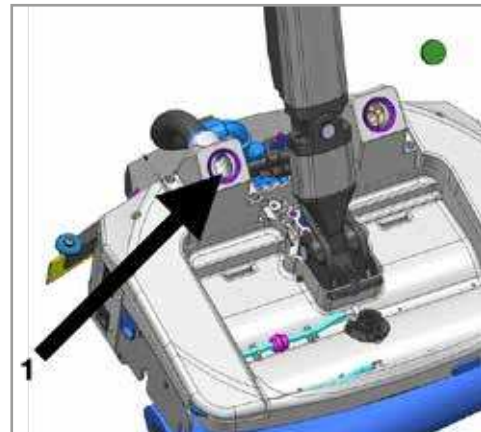

7

Remove hair/dirt around the brush support.

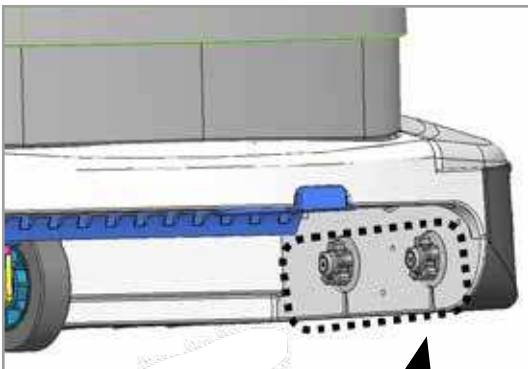

REMOVE DIRT

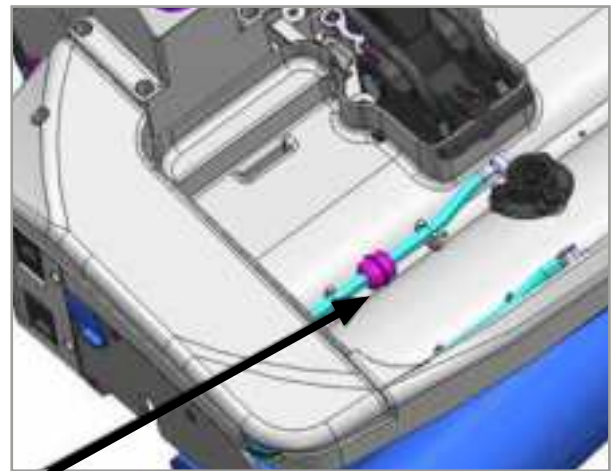

8

Ensure the water filter is clean.

9

Check the spray nozzle.

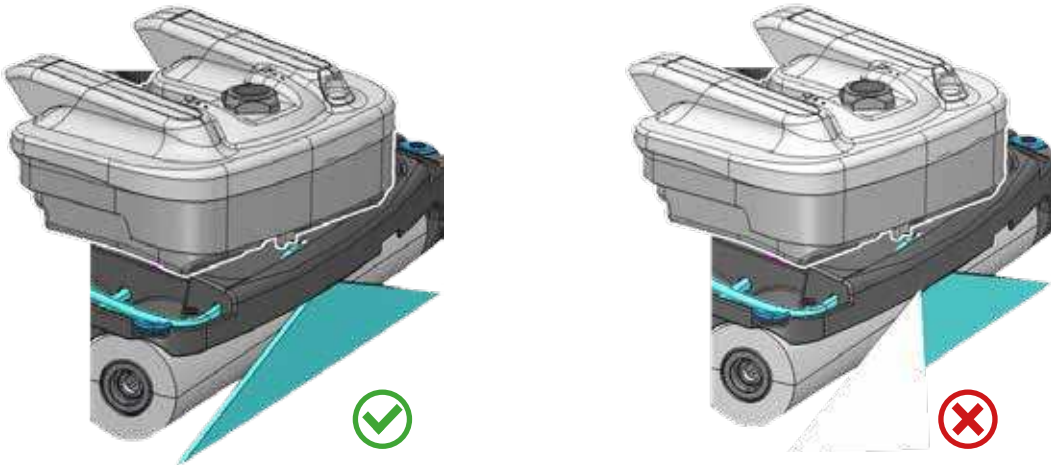

10

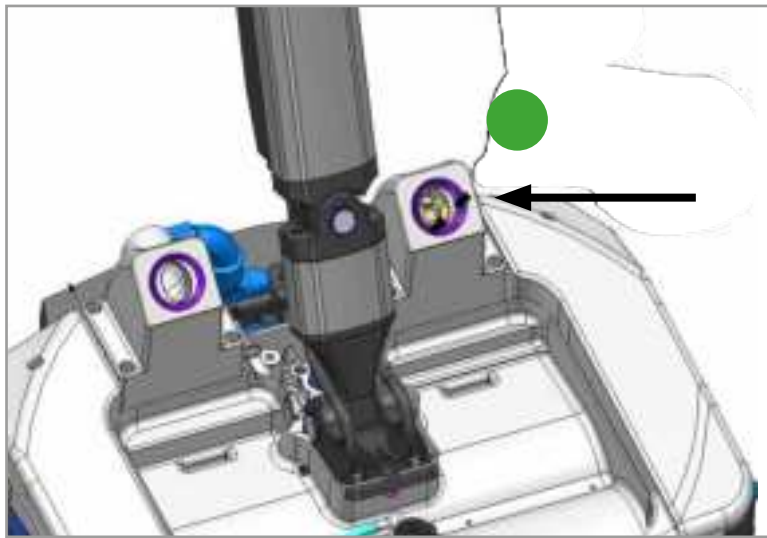

Wash the air filter.

11

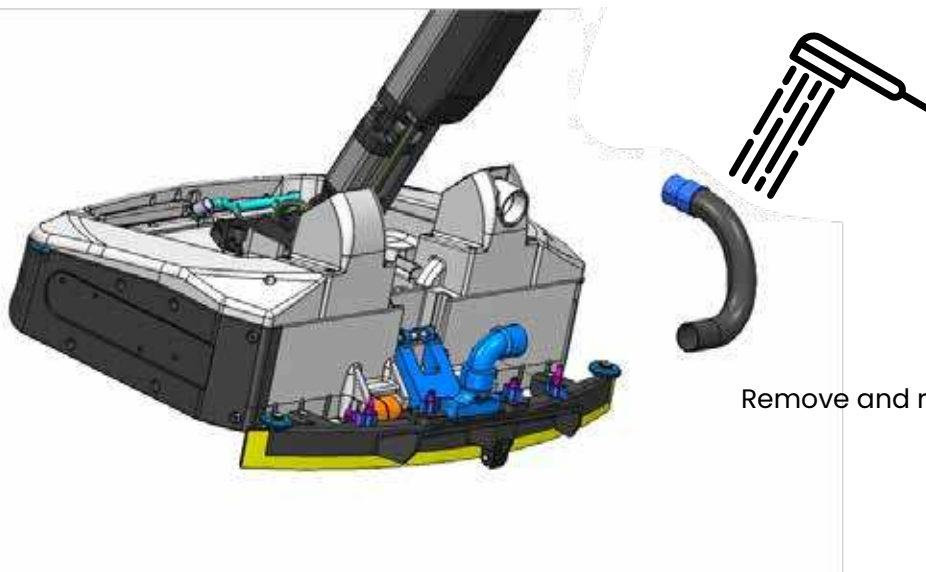

Remove and rinse the suction hose.

TECHNICAL DATA

ultra45

Specification / Specifica / Spécification / Specificatie / Especificación / Especificação	Value
Working surface	1600 m ² /h
Washing width	43 cm
Dimensions (H×W×L)	1150×490×450 mm
Number of brushes	2
Power supply	36 V Lithium battery
Frequency	—
Noise level	< 70 dBA
Solution tank	3.5 L
Recovery tank	4.2 L
Brush speed	Up to 1000 rpm
Weight	18 kg
Unloaded with battery	12 kg
Total power	360 W
Battery run time	Up to 180 min
Charging time	150 min
Packaging dimensions	1310×550×400 mm
Hand-arm vibration	0.8 m/s ²
Water ingress rating	IPX3
Vac motor max power	100 W
Brush/Pad pressure	19 g/cm ²

TROUBLESHOOTING

EN	PROBLEM	CAUSES & SOLUTIONS
	Poor water pickup	Loose/blocked hose, missing seal, or debris. Fix connections, clean out.
	No water flow	Filter/nozzle/pump blocked; clean or replace.
	Brush motor stops	Debris jam; remove tray/brushes and clean thoroughly.
	Brushes slow	High-friction floor; switch to microfiber rollers.

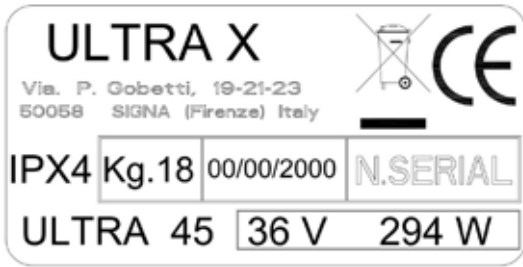

EN	RATING LABEL
	1. Company
	2. Machine description
	3. Weight



**Use & Maintenance**

- Always use caution with electrical equipment.
- Perform routine/preventive maintenance for safe operation.
- Only trained or supervised operators should use this machine.
- Quote the Model/Serial Number (Rating Plate) when ordering parts.
- The manufacturer is not liable for misuse or improper maintenance.

**Warnings**

- This machine is not for children or persons with limited capability unless supervised.
- Use only specified brushes/pads—others may be unsafe.
- Wear non-slip footwear; use a dust mask in dusty conditions.
- Remove the battery before servicing or cleaning.
- Secure the machine if left unattended.
- Follow detergent/liquid manufacturers' instructions.

**Caution**

- Not suitable for hazardous dust, outdoor use, or wet conditions.
- Indoor use only.
- **Note:** This machine is intended for commercial use.

BATTERY SAFETY & DISPOSAL**1. Defective Batteries**

- Never ship/courier a faulty battery.
- If a battery is damaged (impact, leakage, deformation), treat as defective—do not recharge or use indoors.
- For disposal, immerse it in a saltwater solution (15 g salt/L) in a ventilated area for 2 weeks, then store in a locked, labeled container away from buildings. Comply with local hazardous-waste rules.



(Example of a waste battery storage bin)

2. Handling & Storage

- **Danger:** Improper handling can cause fire/explosion.
- Keep away from children; remove the battery when not in use or during transport.
- Store at -10 °C to 55 °C (preferably under 25 °C, <80% humidity).

- Do not drop, open, or incinerate; avoid direct sun, liquids, or heat.
- Use only **ULTRAX** chargers.



(Example of a protected area with a cage to prevent impact damage, batteries stored securely.)

3. Hazards & First Aid

- Leaking electrolyte can burn skin/eyes. Flush with water for 15 minutes; seek medical help if needed.
- If inhaled, move to fresh air; if ingested, seek immediate care.

4. Fire Fighting

- If safe, remove batteries from heat. Cool with plenty of water or use ABC/Class D extinguishers. Wear protective gear; monitor for re-ignition.

5. Charging & Disposal

- Charge only on a flat surface with the approved ULTRAX charger.
- **Red** = charging, **Green** = charged.
- Dispose of used batteries per local regulations; **do not** mix with household waste.

6. Warranty

- 1 year if used with correct care.
- Using non-ULTRAX chargers voids warranty.

BATTERY LABEL



CE CERTIFICATION PAGE



Floor Scrubbers — Carpet Cleaners — Escalator Cleaners

Duplex International
Via P. Gobetti 19
50058 Signa (FI) Italia

EG-KONFORMITÄTSERKLÄRUNG
EC-DECLARATION OF CONFORMITY
CE-DÉCLARATION DE CONFORMITÉ
CE-DICHIARAZIONE DI CONFORMITÀ
DECLARAÇÃO CE DE CONFORMIDADE



Wir/Me/No us/Noi/Nós

Duplex International S.r.l.
Via P. Gobetti 19
50058 Signa (FI)
ITALY

Erklären in alleiniger Verantwortung, dass das Produkt
Declare under our sole responsibility that the product
Déclarons sous notre seule responsabilité que le produit
Dichiariamo sotto la nostra esclusiva responsabilità che il prodotto
Declaramos sob nossa exclusiva responsabilidade que o produto

Floor Cleaning Machine, Ultrax Ultra45

Auf das sich diese Erklärung bezieht, mit den folgenden Normen übereinstimmt.
To which this declaration relates is in conformity with the following standards.
Auquel se réfère cette déclaration est conforme aux normes.
Al quale si riferisce la presente dichiarazione é conforme alle norme
Ao qual se refere a presente declaração está em conformidade com as normas

EN 55014-1:2017, EN 55014-2:2021, EN 60335-1:2020 + A1:2022, EN 60335-2-72:2016 + A11:2021,
EN 62233:2008, EN 62133-2:2017

gemäß den Bestimmungen folgender Richtlinien
Following the provisions of Directives
conformément aux Disposition des Directives
conformemente alle disposizioni e Direttive
Em conformidade com as disposições e Diretivas

2014/30/EU (CEM), 2006/42/EC (DM), 2011/65/EU (RoHS)

(Ort und Datum der Ausstellung)
(Place and Date of issue)
(Lieu et date)
(Luogo e data)
(Local e data)

Signa (Fi) Italia 07/02/2025

(Name, Unterschrift und Funktion des Befugten)
(Name, signature and function of authorized person)
(Nom, signature et fonction du signataire autorisé)
(Nome, firma e funzione del firmatario)
(Nome, assinatura e função do signatário)

Leonardo Lunardi
CEO



CONTACT INFORMATION

Via P. Gobetti, 19-21-23 – 50058 Signa (FI), Italy

Tel: +39 055876437 | WhatsApp: +39 379 183 3783

www.ultrax-global.com

Made in Florence



Via P. Gobetti, 19-21-23 - P.O. 50058, Signa, Firenze (Italy)
Telephone: +39 055876437
Whatsapp message +39 379 183 3783
www.ultrax-global.com